

INSTALLATION

1. INSTALL STEERING COLUMN ASSEMBLY

Install 6 bolts, 1 nut with steering column assembly.

Torque:

Bolt: 18 N·m (185 kgf·cm, 13 ft·lbf)

Nut: 21 N·m (210 kgf·cm, 15 ft·lbf)

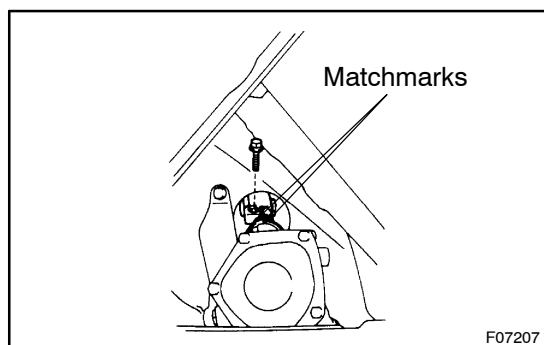

2. CONNECT SLIDING YOKE

(a) Align the matchmarks on the control valve shaft and sliding yoke.

(b) Install the bolt.

Torque: 35 N·m (360 kgf·cm, 26 ft·lbf)

3. INSTALL SPIRAL CABLE (See page BE-7)

4. INSTALL COMBINATION SWITCH WITH SPIRAL CABLE

(a) Install the combination switch with 3 screws.

(b) Connect 3 connectors.

(c) Connect the airbag connector.

5. INSTALL LOWER RH FINISH PANEL

(a) Connect the speaker connector.

(b) Install the lower RH finish panel with the screw.

6. INSTALL FUEL LID OPENER

Install the fuel lid opener with 2 screws.

7. INSTALL UPPER AND LOWER COLUMN COVERS

Install the upper and lower column covers with 3 screws.

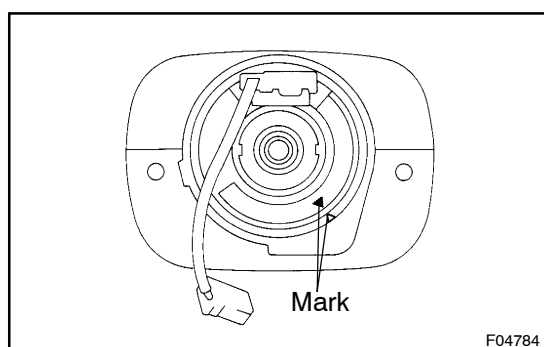

8. CENTER SPIRAL CABLE

(a) Check that the front wheels are facing straight ahead.

(b) Turn the cable counterclockwise by hand until it becomes harder to turn the cable.

(c) Then rotate the cable clockwise about 3 turns to align the mark.

HINT:

The cable will rotate about 3 turns to either left or right of the center.

9. INSTALL STEERING WHEEL

(a) Align the matchmarks on the steering wheel and main shaft.

(b) Install the steering wheel and steering wheel set nut.

Torque: 34 N·m (350 kgf·cm, 25 ft·lbf)

(c) Connect the connector.

10. INSTALL STEERING WHEEL PAD**NOTICE:**

- Make sure the wheel pad is installed to the specified torque.
- If the wheel pad has been dropped, or there are cracks, dents or other defects on the case or connector, replace the wheel pad with a new one.
- When installing the wheel pad, take care that the wirings do not interfere with other parts and are not pinched between other parts.

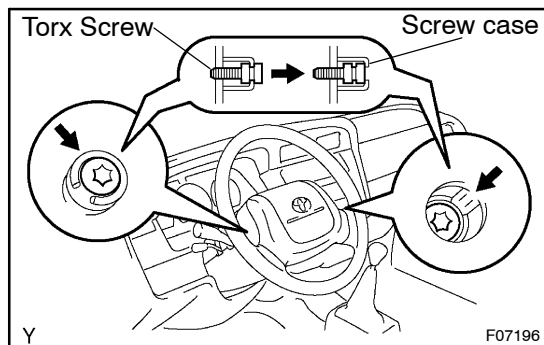

- (a) Connect the airbag connector.
- (b) Install the pad after confirming that the circumference groove of the torx screw is caught on the screw case.
- (c) Using a torx socket wrench (T30), torque 2 screws.

Torque: 8.8 N·m (90 kgf·cm, 78 in·lbf)

- (d) Install 2 steering wheel lower No. 2 covers.

11. CHECK STEERING WHEEL CENTER POINT